

## Location Map



## Location Highlights

20 Mins drive from Electronics Hardware SEZ at Maheswaram | 30 Mins drive from Outer Ring Road | 35 Mins drive from Rajiv Ghandi International Airport | 25 Mins drive from Rajiv Gandhi - Nano Technology Park / Fab City | 25 Mins- drive from APIIC Industrial Park | 35 Mins drive Hardware Park - HCL, Genpact, Kernex Micro Systems Agakhan Foundation- Gems Park, Raheja IT SEZ | 35 Mins drive from TATA's Aero Space SEZ - Adibatla IT Park, TCS & Cognizant, DELL SEZ, Indu Point IT SEZ, Brahmani IT SEZ  
**5 Mins drive from Hyderabad Pharma City**

## Projects Highlights

- ➔ Clear Title
- ➔ DTCP Approved Layout
- ➔ Vaastu Compliant
- ➔ Black Top Roads
- ➔ Children Play Area
- ➔ Commercial Plantation
- ➔ Underground Drainage
- ➔ Underground water supply to each Plot
- ➔ Electricity
- ➔ Water Sump
- ➔ Badminton N Volleyball Court
- ➔ Club House With Swimming Pool

- ➔ INTRODUCING 1ST TIME IN KADTHAL URBAN FOREST(Miyawaki)
- ➔ HERBAL GARDEN(MEDICINE)



T.L.P No. 70/2020/HRO/H1



**BOOK YOUR DREAM PLOT TODAY !!**  
 1 Kg Silver With Every Booking | Offer Valid Only For First 10 Customers | First Come First | Limited Offer



Marketing by

**Pruthvi Avenues (P) Ltd.**

Regd. Off. 6-3-664, Flat No . 301, Prestige Rai Towers, Opp. NIMS Hospital, Panjagutta, Hyderabad - 500082.  
 Web : [www.pruthvipyramidcity.com](http://www.pruthvipyramidcity.com)





Pruthvi Avenues (P) Ltd.

# Proposed Layout Plan In Sy.No.260/39/P Of Anmasapally Gram Panchayat, Kadthal Mandal, RR District.



T.L.P No. 70/2020/HRO/H1

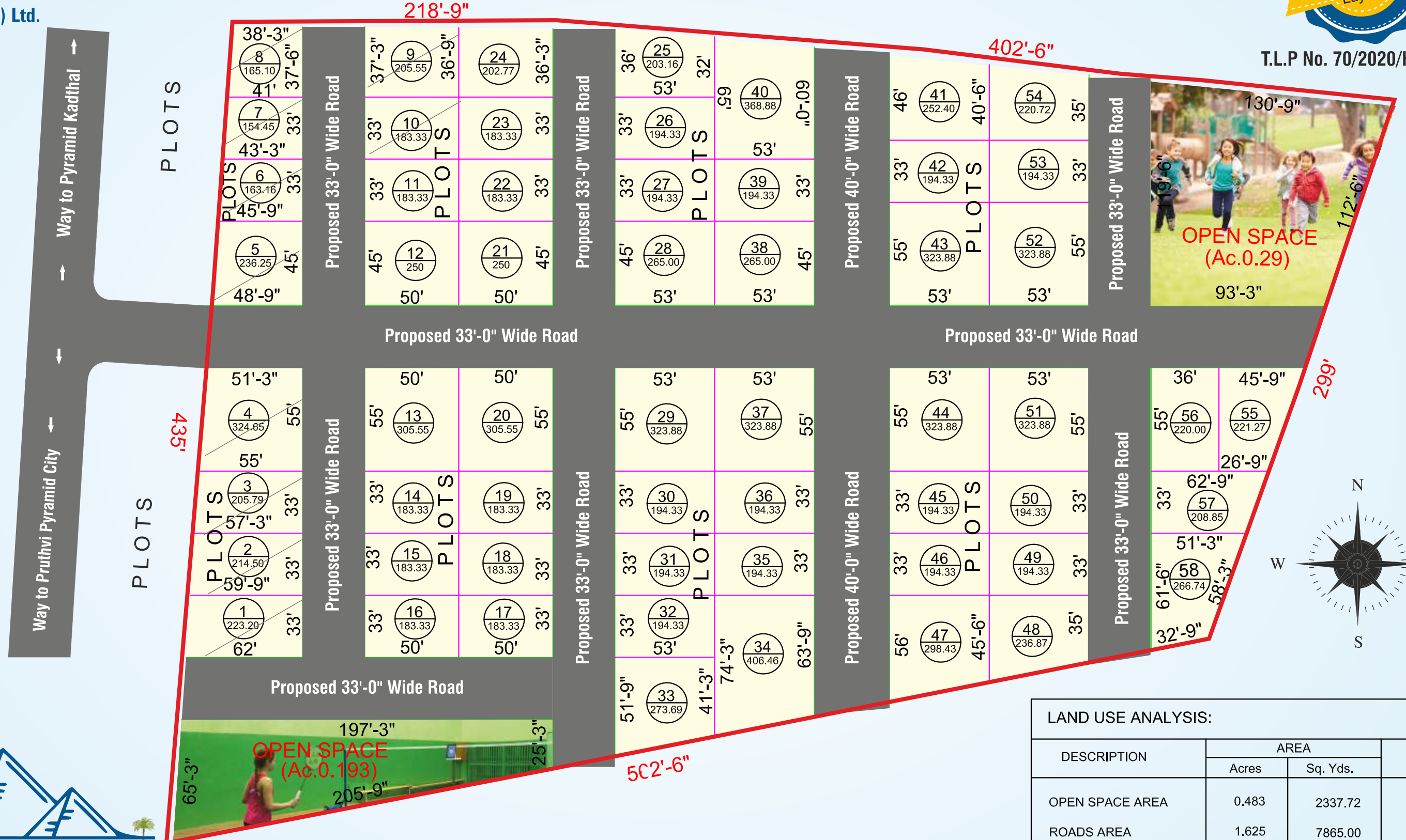

LAND USE ANALYSIS:			
DESCRIPTION	AREA		%
	Acres	Sq. Yds.	
OPEN SPACE AREA	0.483	2337.72	10.01
ROADS AREA	1.625	7865.00	33.68
PLOTTED AREA	2.717	13150.28	56.31
LAYOUT AREA	4.825	23353.00	100.00